



Laser class 2 in acc. with IEC 60825-1

[www.disto.com](http://www.disto.com)



SAP. No. 792 313

## Insert batteries

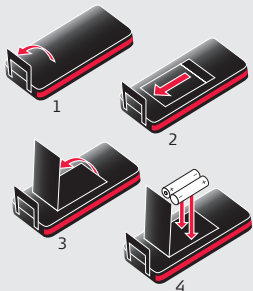

## Operation



ON Measure OFF

## Endpiece

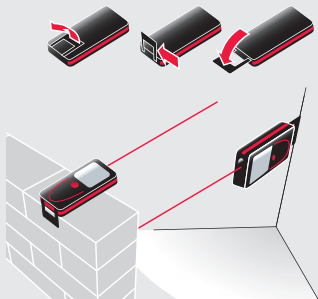

## Overview

- 1 Status Bar/Level
- 2 Reference
- 3 Active Function
- 4 Main Line (Result)
- 5 Selection keys linked to the symbol above
- 6 ON/DIST
- 7 Pointfinder (viewscreen)
- 8 Function Screen
- 9 Navigation
- 10 Clear/Off
- 11 Add/Subtract

## Unlock keypad

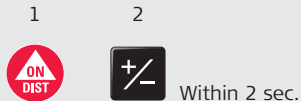

## Quick Start

### Leica DISTO™ D510

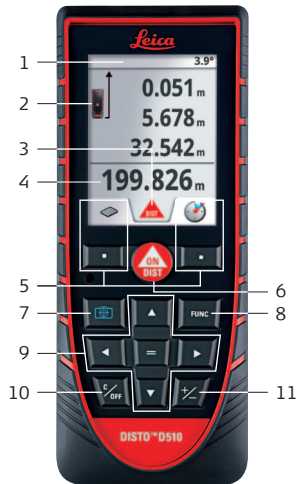

- when it has to be right

**Leica**  
Geosystems

## (Navigate) Functions

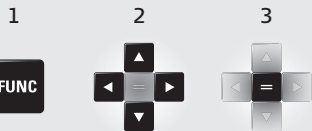

## Reference/Tripod



## More Results

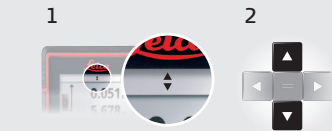

## Pointfinder

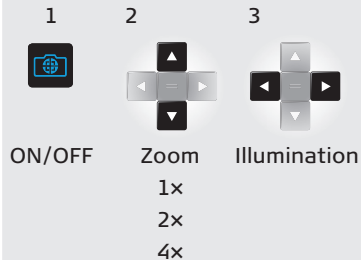

## Settings

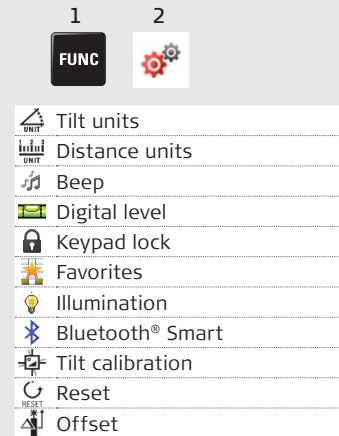

## Memory

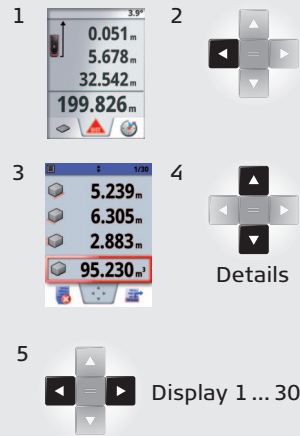

## ? Helpfunctions

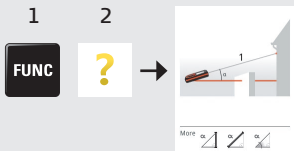

## Personalized Favorites

